

EuroPlan/EuroProfil Panel radiators

BRÖTJE
HEIZUNG
Member of BAXI GROUP Ltd.



SHAPELY HEATING COMFORT

Low temperature panel radiators for convenient heating.
Easy installation using the Multi-Fix mounting system.



...better with Brötje

EVEN LESS IS EVEN MORE

2

A good heating system makes your house a true home – all the more when the visible elements of your heating system harmoniously match your interior design. Those who prefer an unobtrusive design without compromising functionality should go for EuroPlan radiators. The classic, straight, rectangular shape, which is nicely softened by smoothly rounded edges, stands out from the monotonous appearance of conventional radiators. This not only goes for the design but also for the workmanship: The smooth surface has no seams, ridges or weld spots. The high-grade powder stove-enamel finish gives a regal design and a long service life, and the invisible fasteners provide an impression of airiness.

The heat output can be adjusted to exactly suit individual needs. Installation is faster than ever using the BRÖTJE Multi-Fix mounting system. EuroPlan Excellent comes with a valve set as well as a valve insert with integral k_v control. A range of thermostats can be obtained from specialised dealers. Whether working on a new building or modernising an old one: now is the time to make it better. It's better with BRÖTJE.



The BRÖTJE EuroPlan panel radiators are available in the designs Kompakt and Excellent. Besides their superior design, they offer a special advantage: With their smoothly rounded, soft edges, they are excellently suited for public buildings, schools and nurseries.



CLASSICAL DESIGN THAT STANDS OUT FROM THE ORDINARY.

4

With their favourable proportions of radiation and convection, the classical BRÖTJE EuroProfil panel radiators not only produce a pleasing, homogeneous room climate, but their elegant design meets even exacting aesthetic demands.

The large range of models includes a suitable radiator for any room, thereby complying with individual, particular heating requirements.



EuroProfil Standard:

Low space requirement thanks to an extremely flat design. Clear, timelessly elegant profile.

EuroProfil Kompakt:

Similar to EuroProfil Standard, but with smoothly rounded blinds and a top cover. All blinds can be removed for easy and convenient cleaning.



EuroProfil Excellent:

Similar to EuroProfil Kompakt. Comes with a set of valves for double pipe systems and a valve insert with integral k_v control.



FUNCTIONING AT IT'S BEST

6

Swift and easy.

The BRÖTJE Multi-Fix mounting system enables extremely swift and clean installation and offers a range of other benefits: The fasteners can be adjusted horizontally. There are two possibilities of height adjustment. If needed, additional fasteners may be provided. The radiator may even be rotated. Furthermore, the covers can be conveniently removed so that cleaning is a breeze.

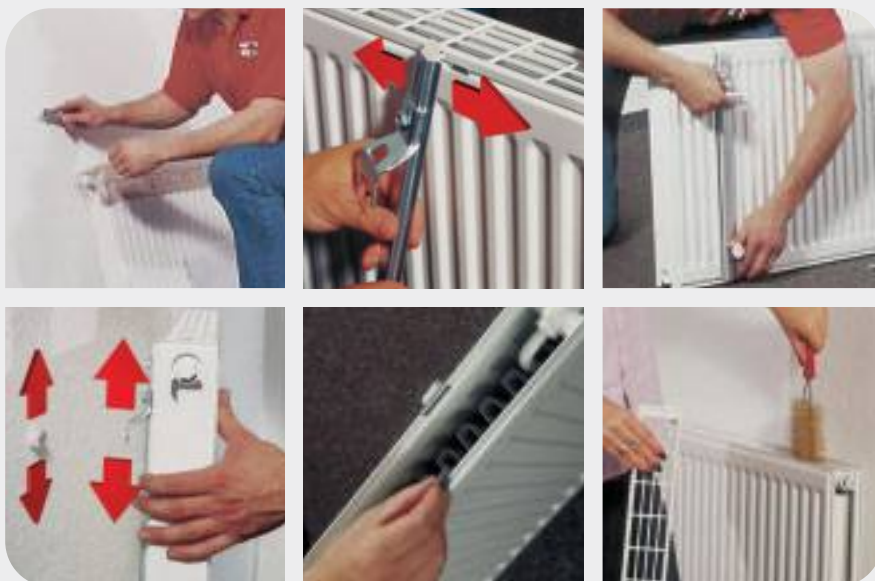

Dimensions EuroPlan/EuroProfil

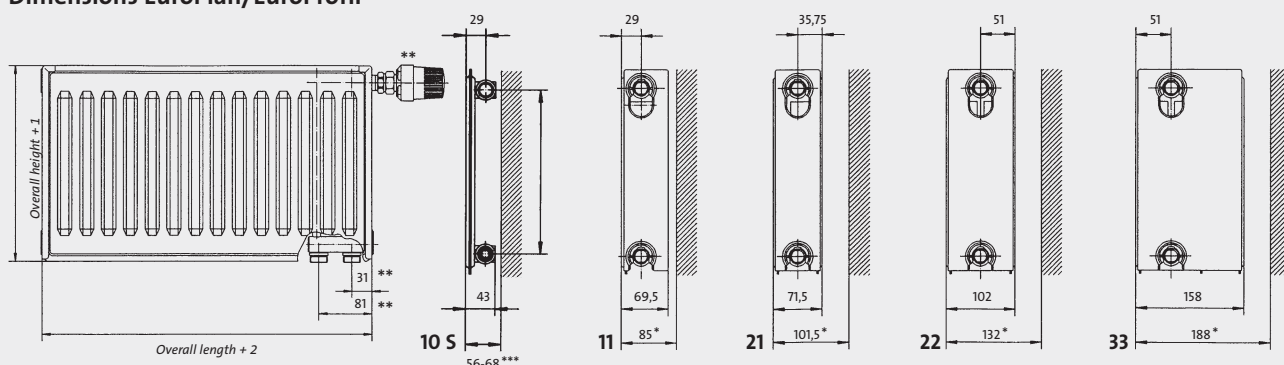

* Installation dimensions when using BRÖTJE Multi-Fix mounting system. **In standard version, connection of flat valve radiators (Excellent) is on the right (connection on the left as tailored design). *** "Spacer set" required as accessories for Multi-Fix mounting system. Subject to technical modifications and errors.

Flexible use

BRÖTJE flat valve radiators of the Excellent series are supplied with six connections so that they may act as multifunction panel radiators. When needed, they can be swiftly used as "Kompakt" panel radiators simply by removing the valve insert and by sealing the lower connections with brass caps (accessories). All flat valve radiators made by BRÖTJE come with mounted valve insert as well as a sealed blind and a bleeding plug.

