

Position	Qty.	Description	Single Price
	1	CH 2-30 A-W-A-AQQE  <p>Note! Product picture may differ from actual product</p> <p>Product No.: 43482103 Horizontal centrifugal multi-stage pump.</p> <p>Multi-stage centrifugal pump with axial suction port and radial discharge port close-coupled with a single-phase motor with thermal overload protection. Pump and motor are mounted on a common baseplate.</p> <p>The pump has a mechanical shaft seal.</p> <p>Impellers, intermediate chambers and shaft are made of stainless steel. Suction and discharge chambers are made of Cast iron.</p> <p>Liquid: Liquid temperature range: 0 .. 90 °C Liquid temp: 20 °C Density: 998.2 kg/m³</p> <p>Technical: Actual calculated flow: 2.5 m³/h Resulting head of the pump: 18.5 m Shaft seal: AQQE</p> <p>Materials: Pump housing: Cast iron EN-JL1030 ASTM 30 B Impeller: Stainless steel DIN W.-Nr. 1.4301 AISI 304</p> <p>Installation: Range of ambient temperature: 0 .. 55 °C Max pressure at stated temp: 6 bar / 90 °C 10 bar / 40 °C Pump inlet: Rp 1 Pump outlet: Rp 1</p> <p>Electrical data: Motor type: MG71 Power input - P1: 480 W Mains frequency: 50 Hz Rated voltage: 1 x 220-240 V Rated current: 2.3 A</p>	Price on request

Position	Qty.	Description	Single Price
		Capacitor size - run: 10 μ F/400 V Enclosure class (IEC 34-5): 54 Insulation class (IEC 85): F Others: Net weight: 9.6 kg Gross weight: 11.4 kg Shipping volume: 0.019 m3	

43482103 CH 2-30 50 Hz

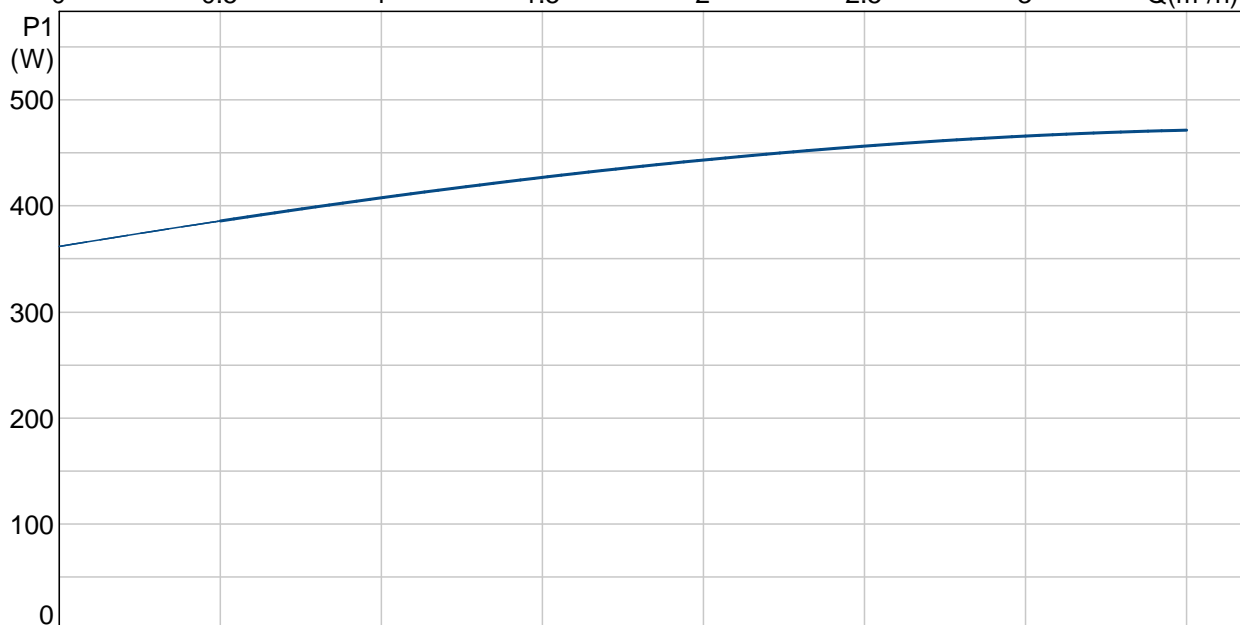
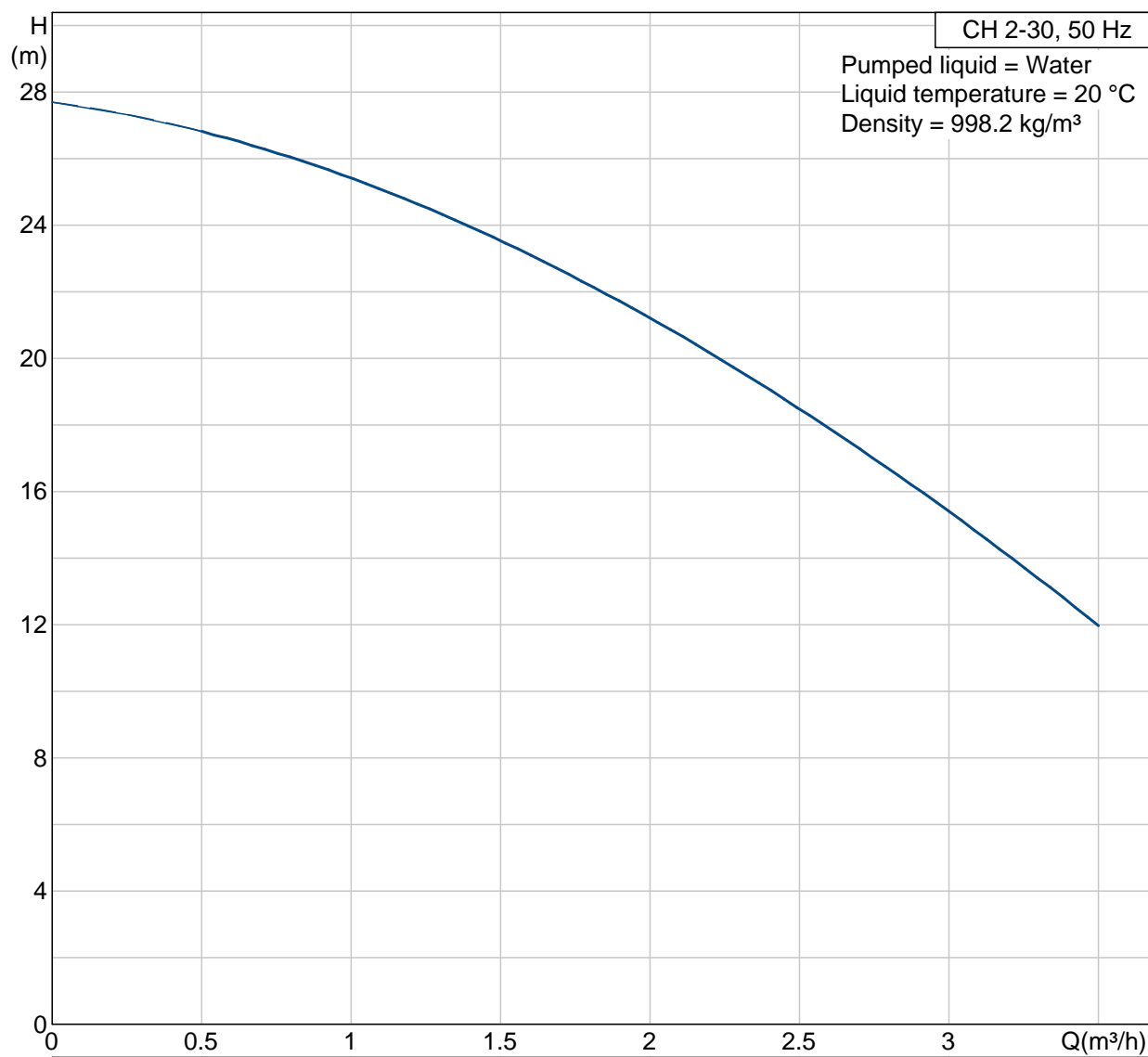

43482103 CH 2-30 50 Hz

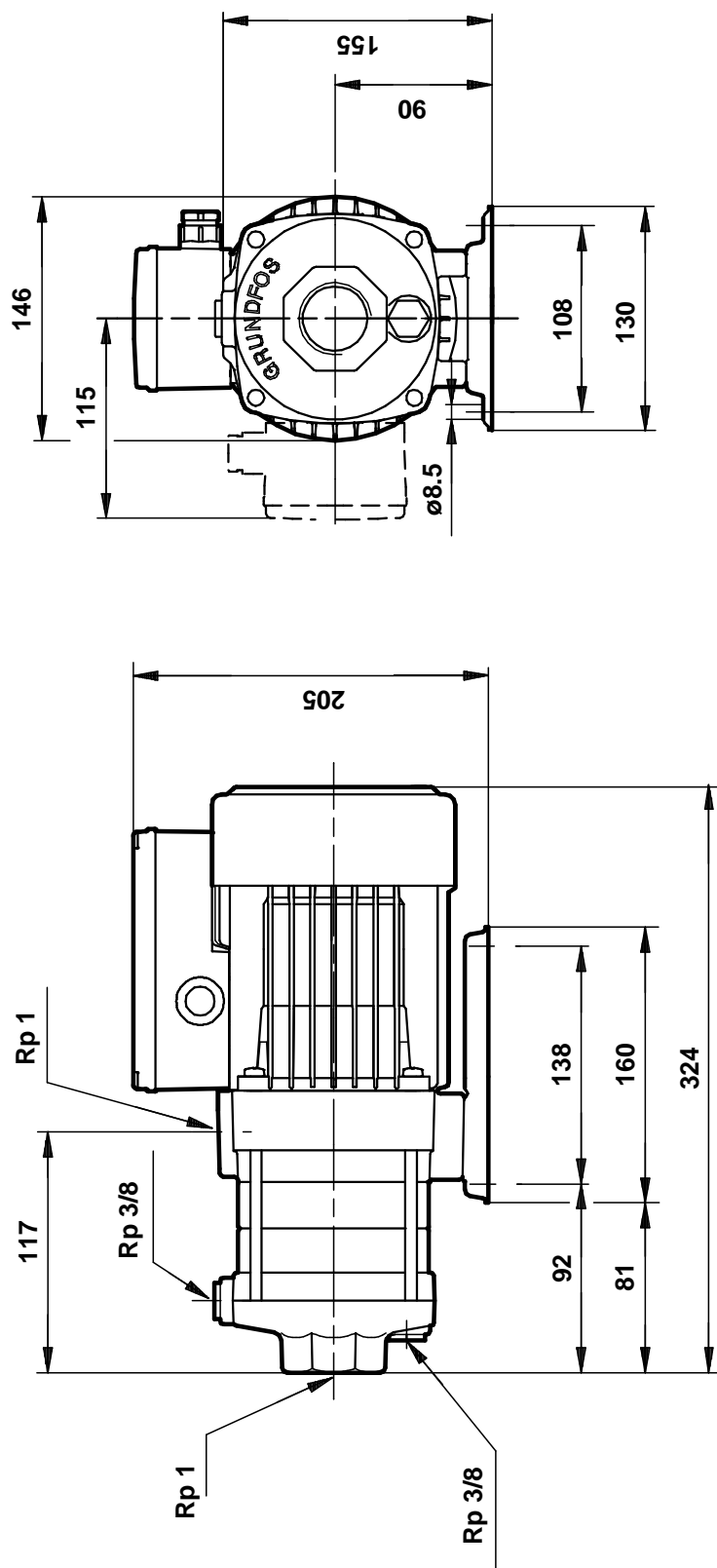

Note! All units are in [mm] unless others are stated.
Disclaimer: This simplified dimensional drawing does not show all details.