

Position	Qty.	Description	Single Price
	1	<b>CH 2-40 A-W-A-AQQE</b>  <p><b>Note! Product picture may differ from actual product</b></p> <p>Product No.: 43482104 Horizontal centrifugal multi-stage pump.</p> <p>Multi-stage centrifugal pump with axial suction port and radial discharge port close-coupled with a single-phase motor with thermal overload protection. Pump and motor are mounted on a common baseplate.</p> <p>The pump has a mechanical shaft seal.</p> <p>Impellers, intermediate chambers and shaft are made of stainless steel. Suction and discharge chambers are made of Cast iron.</p> <p><b>Liquid:</b> Liquid temperature range: 0 .. 90 °C Liquid temp: 20 °C Density: 998.2 kg/m<sup>3</sup></p> <p><b>Technical:</b> Actual calculated flow: 2.5 m<sup>3</sup>/h Resulting head of the pump: 24.4 m Shaft seal: AQQE</p> <p><b>Materials:</b> Pump housing: Cast iron EN-JL1030 ASTM 30 B Impeller: Stainless steel DIN W.-Nr. 1.4301 AISI 304</p> <p><b>Installation:</b> Range of ambient temperature: 0 .. 55 °C Max pressure at stated temp: 6 bar / 90 °C 10 bar / 40 °C Pump inlet: Rp 1 Pump outlet: Rp 1</p> <p><b>Electrical data:</b> Motor type: MG71 Power input - P1: 570 W Mains frequency: 50 Hz Rated voltage: 1 x 220-240 V Rated current: 2.6 A</p>	Price on request

Position	Qty.	Description	Single Price
		Capacitor size - run: 10 $\mu$ F/400 V Enclosure class (IEC 34-5): 54 Insulation class (IEC 85): F  <b>Others:</b> Net weight: 10.9 kg Gross weight: 11.5 kg Shipping volume: 0.019 m3	

## 43482104 CH 2-40 50 Hz

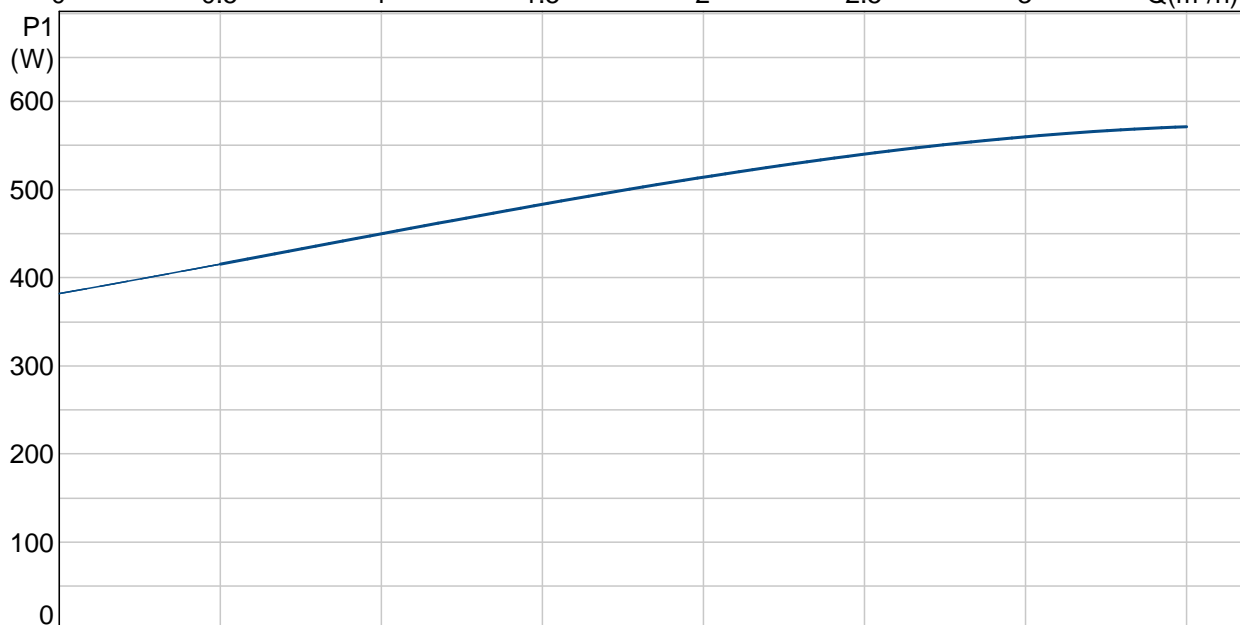
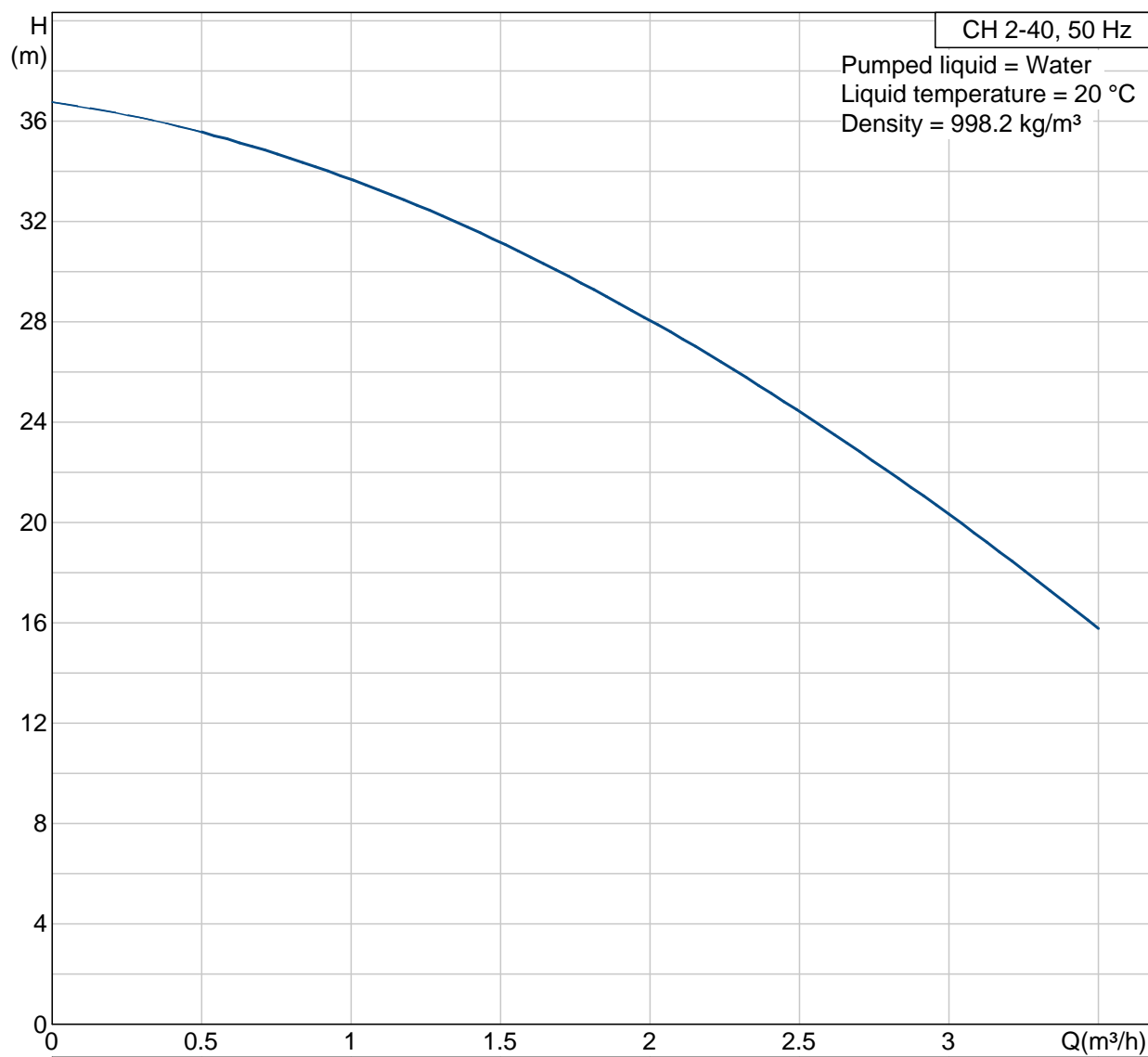

**43482104 CH 2-40 50 Hz**

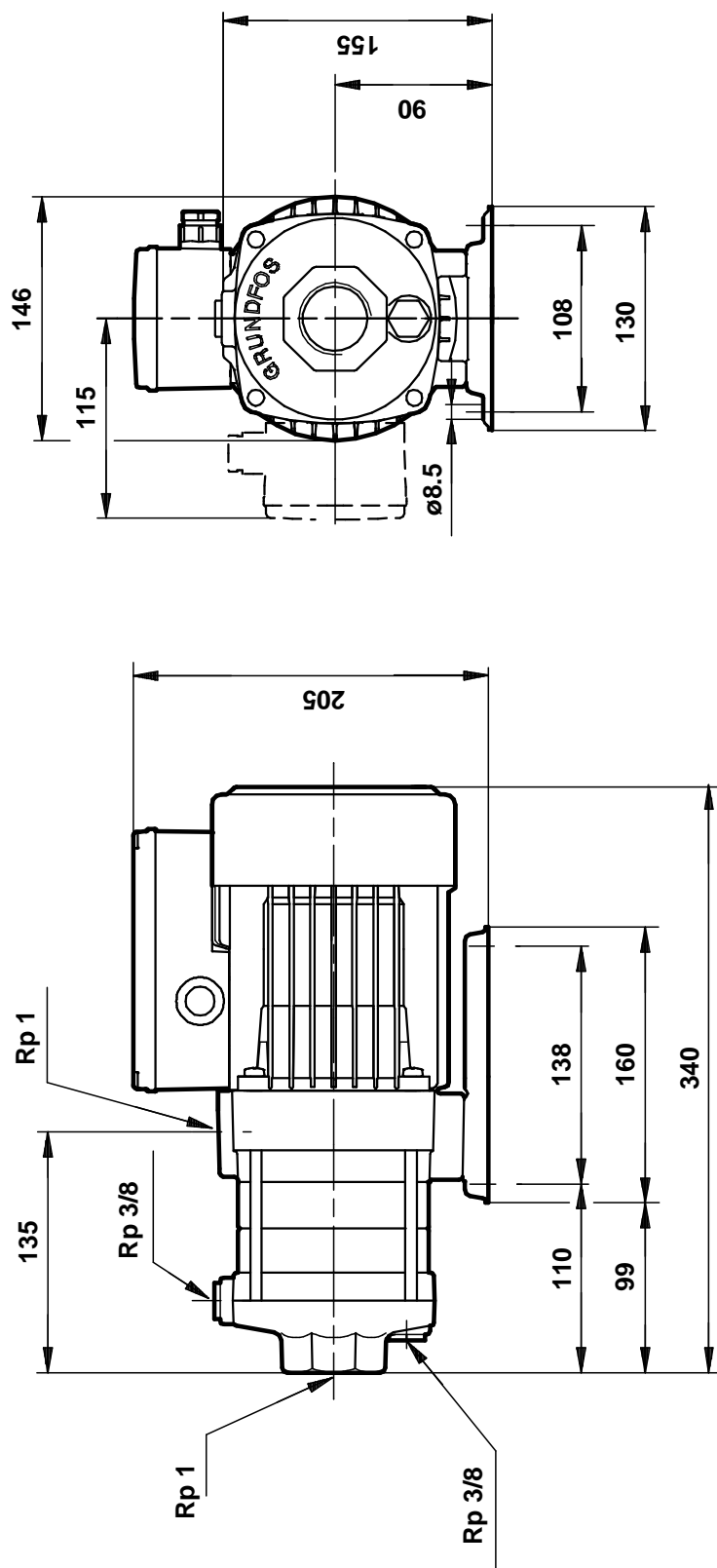

Note! All units are in [mm] unless others are stated.  
Disclaimer: This simplified dimensional drawing does not show all details.